



2006 Audi A3

Product Information

Version 2



A3 2.0T 200hp manual front
A3 2.0T 200hp DSG front



Table of Content

3	General Information
5	Sport Package
6	Premium Package
7	Equipment
9	Options
11	Color / Trim Program
12	Wheel Program
13	Specifications

DSG - option

Tiptronic shift gate
Steering wheel paddle controls
Double clutch system
No loss of power and no slip while shifting due to preselected gears
One gear is continuously engaged during driving operations
Technology dates back to 1985 with Audi Sport quattro S1



Open Sky System - option

exterior

roof spoiler
will be
black with
Sport Pkg



interior

Storage Pkg I - Standard on all

Cargo net in the trunk
Power outlet in trunk
Net on the side in the trunk



Storage Pkg II - Standard Premium

Net on the back of the driver/ passenger seats
Net on the passenger side
Tray under the driver seat
Hooks for bags in trunk



Steering wheel

new generation

4 spoke



sport
premium



Cloth "Modul" - standard

available in

black

beige

gray

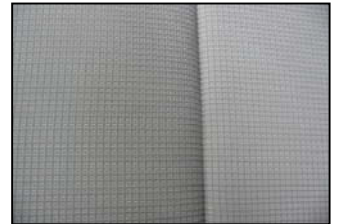

New Parking Brake Design - standard

to save space for the cupholder



Cup Holder (only for NAR) - standard



Sport Pkg

- 17" 16-spoke bicolor alloy wheels
- US performance tires standard and all season tires no cost option
- Canada all season tires standard and performance tires no cost option
- roof spoiler
- sport seats
- 3-spoke MFL (DSG: with alloy paddles)
- air vents and door inlays in alloy
- alloy inlays
- Leather seating surfaces with colored stiches
- illuminated vanity mirrors
- driver/passenger reading lights
- lighted door open
- radio button in alloy
- front fog lights

power exterior mirrors



aluminum inlays

trunk release and fuel door release buttons



roof spoiler (w/o OSS in body color)

aluminum paddles

air vents alloy



cruise control

3-spoke Multi function Steering wheel



colored stiches



sport seats available only in leather: beige, gray, black



bicolor

standard for all A3 =

Premium Pkg

- 17" 16-spoke silver alloy wheel, all season tires
- HomeLink® universal garage door opener
- Storage Pkg (QE1)
- Trip Computer
- Light/Rain Sensor w/ auto dim mirrors
- 3-spoke MFL (DSG: with paddles)
- power driver seat with lumbar
- Leather seating surfaces
- front fog lights
- illuminated vanity mirrors
- driver/passenger reading lights
- lighted door open
- alloy inlays

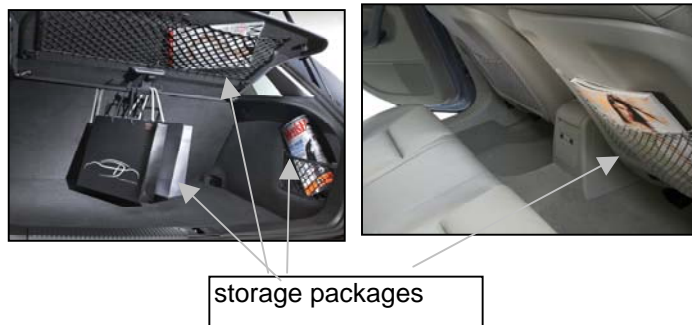
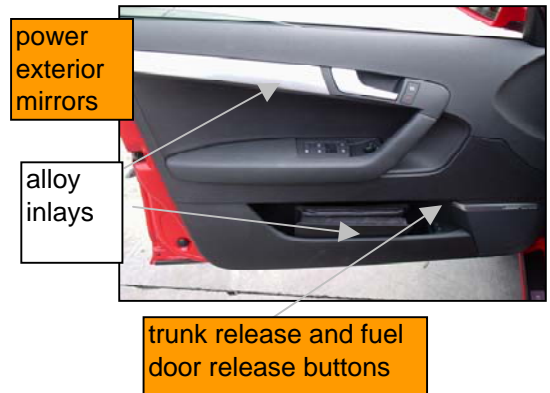
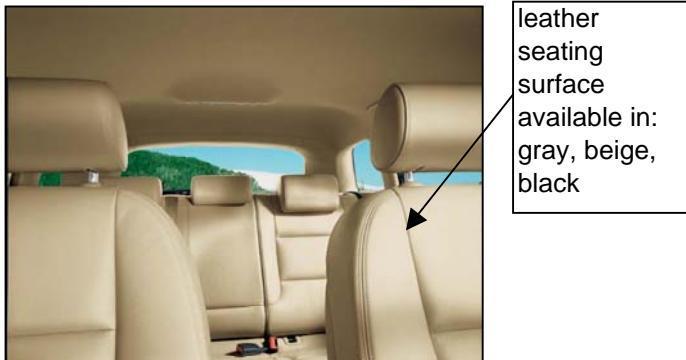
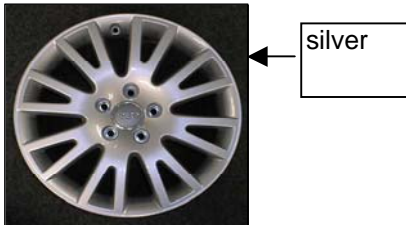
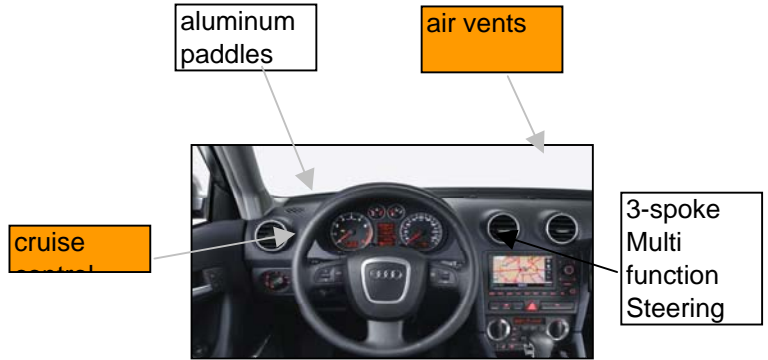



Legend X = Standard O = Optional - = Not available	2.0T	2.0T Sport	2.0T Premium
Technical			
<ul style="list-style-type: none"> ● 2.0 liter turbocharged DOHC 200 hp 4-cylinder spark-ignition with petrol direct injection, exhaust turbocharger with intercoller, 4 valves per cylinder, double overhead camshafts (DOHC) ● 3.2 liter 250 hp 6-cylinder spark-ignition engine, DOHC ● 6-speed manual transmission with synchronized reverse gear, dual mass flywheel ● Direct Shift Gearbox (DSG) automatic transmission with steering wheel control paddles ● Front wheel drive ● quattro® - permanent all-wheel drive system, includes Haldex® coupling ● Anti-lock brake system (ABS) with electronic differential lock (EDL) ● ASR (Anti-Slip Regulation) full time traction control ● ESP (Electronic Stabilization Program) 	x	x	x
Wheels / Tires / Suspension / Steering			
<ul style="list-style-type: none"> ● 7.5Jx17 (ET 32) 5-spoke star cast alloy wheels with 225/45 R17 all season tires ● 7.5Jx17 (ET32) 16-spoke bicolor wheel with 225/45 R 17 with performance tires (US) Canada all season tires ● 7.5Jx17 (ET32) 16-spoke silver wheel with 225/45 R 17 with all season tires ● 7.5Jx17 (ET32) excalibur alloy wheel with 225/45 R 17 performance tires ● MacPherson front suspension with direct anti-roll bar mountings, seperatel installed springs and shock absorber pivots and five-piece alumnium subframe ● Independent-wheel four -link suspension according to the multilink principle and seperation absorption of longitudinal and lateral forces ● Tilt and telescopic (manual) adjustable steering column 	x	-	x
	-	x	-
	-	-	x
	-	-	-
	x	x	x
	x	x	x
	x	x	x
Exterior			
<ul style="list-style-type: none"> ● 2.5 MPH (US Federal standard) integrated bumpers in body color (for Canada 5 MPH Canadian) ● Body color outside mirrors ● Aluminum door sill trim with Audi logo ● Fixed roof spoiler 	x	x	x
	x	x	x
	-	x	-
	-	x	-



Legend	2.0T	2.0T Sport	2.0T Premium
X = Included in Package			
O = Optional			
- = Not available			
Trim Pkg			
<ul style="list-style-type: none"> • Sport Model <ul style="list-style-type: none"> - 17"16-spoke bicolor alloy wheels US: performance tires standard and all season tires no cost option Canada: all season tires standard and performance tires no cost option - roof spoiler - sport seats - 3-spoke MFL (DSG: with alloy paddles) - air vents and door inlays in alloy - radio button in alloy - alloy inlays - Leather seating surfaces with colored stiches - illuminated vanity mirrors - driver/passenger reading lights - lighted door open - front fog lights • Premium Model <ul style="list-style-type: none"> - 17" 16-spoke silver alloy wheels - HomeLink® universal garage door opener - Storage Pkg (QE1) - Trip Computer - Light/Rain Sensor w/ auto dim mirrors - 3-spoke MFL (DSG: with paddles) - power driver seat with lumbar - Leather seating surfaces - illuminated vanity mirrors - driver/passenger reading lights - lighted door open - alloy inlays - front fog lights 	-	s	-
Options			
<ul style="list-style-type: none"> • Sound Pkg <ul style="list-style-type: none"> - Bose® premium sound svstem with four speakers in door. two 2-wav rear speakers. center speaker in dashboard, subwoofer between the seats, 225W amplifier and Audio Pilot technology (195 Watt) - 6-disc CD changer¹ (located in storage compartment next to left rear seat) • Cold Weather Pkg <ul style="list-style-type: none"> - heated front seats - ski sack - heated windshield nozzles - heated outer mirrors • Convenience Pkg <ul style="list-style-type: none"> - Homelink - Storage Pkg - Trip Computer - Light/Rain sensor w/ auto dim mirror 	-	o	o
	-	o	o
	-	soo	-



Legend	2.0T	2.0T Sport	2.0T Premium
X = Included in Package			
O = Optional			
- = Not available			
Separate options			
• DSG	o	o	o
• Open Sky System	soo	o	o
• Metallic	o	o	o
• Rear side airbag	o	o	o
• Xenon	-	o	o
• Satellite Radio (XM or Sirius)	-	o	o
• 17" 16-spoke bicolor all season tires (US)	-	nc	-
• 17" 16-spoke bicolor performance tires (CAN)	-	nc	-
• Premium leather	-	-	-
• Phone Preperation* (available CW22/05)	-	soo	o
• DVD NAV	-	soo	o

s = standard
o = option
- = not available
soo = sold order only

Warranty Information for all models

United States / Canada

- 4-year/50,000 mile new vehicle limited warranty / 4-year / 80,000 km new vehicle limited warranty
- 4-year/50,000 mile no-charge scheduled maintenance / 4-year / 80,000 km no-charge scheduled maintenance
- 12-year limited warranty against corrosion perforation
- 24-hour Roadside Assistance for 4 years

"quattro" is a registered trademark of Audi AG
 "Audio Pilot" is a registered trademark of Bose Corporation
 "Motorola" is a registered trademark of Motorola, Inc.
 "Bose" is a registered trademark of the Bose Corporation. Covered by patent rights issued and/or pending.
 "Haldex" is a registered trademark of Haldex Traction Systems, Sweden
 "HomeLink" is a registered trademark of Johnson Controls, Inc.



Version 2

<u>Exterior Colors</u>	<u>Interior Colors</u>
<ul style="list-style-type: none"> ● Brilliant Black A2 A2 (Y9B) 	Black Beige Light gray
<ul style="list-style-type: none"> ● Brilliant Red C8 C8 (Y3J) 	Black
<ul style="list-style-type: none"> ● Ocean Blue pearl effect 2Y 2Y (Z5C) 	Beige Light gray
<ul style="list-style-type: none"> ● Lava Gray pearl effect 1R 1R (Z7L) 	Beige Light gray
<ul style="list-style-type: none"> ● Light Silver metallic 5B 5B (Y7W) 	Black Light gray

Special Order

<ul style="list-style-type: none"> ● Artic White B5 B5 (Y9D) 	Black Beige Light gray
<ul style="list-style-type: none"> ● Moro Blue pearl effect P7 P7 (Z5J) 	Black Beige Light gray
<ul style="list-style-type: none"> ● Crimson Red X7 X7 (Z3H) 	<div style="border: 1px solid black; padding: 2px; display: inline-block;"> No offer Crimson Red (=Piemontrot) in NAR. Start with Garnet Red (=Granatrot) CW 22/05 </div> Black Beige Light gray
<ul style="list-style-type: none"> ● Dakar Beige 9X 9X (Y1Q) 	Black Beige Light gray
<ul style="list-style-type: none"> ● Venetian Violet 4H 4H (Z4Z) 	Black Beige Light gray
<ul style="list-style-type: none"> ● Morano Green pearl effect G7 G7 (Z6Q) 	Black Beige Light gray

Upholstery

- Premium leather **beige, black/black, light gray/gray**
- optional equipment for 3.2 quattro S line

Interior Component Colors

Cloth Modul	partial leather	door inlays
beige	beige	black
black	black	black
light gray	light gray	black

for sport and premium pkg: alloy doors inlays 5TD
for S line models: alloy doors inlays (quattro GmbH)

2.0T



5-dome star alloy wheels

7.5J x 17 ET 32

225/45 R 17 all season tires

- only for the Base and Premium Pkg



16-spoke alloy wheels bicolor

7.5J x 17 ET 32

225/45 R 17 performance

225/45 R 17 all season

- only for Sport Pkg



16-spoke alloy wheels silver

7.5J x 17 ET 32

225/45 R 17 all season

- only for Premium Pkg



2006 Audi A3 - Version 2
 Technical Specifications

Technical Specifications		Version 2	2006 A3 2.0T
ENGINE:			
Type	Inline four-cylinder spark-ignition engine with petrol direct injection, exhaust turbocharger with intercooler, four valves per cylinder,		
	double overhead camshafts (DOHC)		
Arrangement	Front mounted, transverse		
	2.0T 200 hp FWD		
Bore	3.2 in.	82.5 mm	
Stroke	3.7 in.	92.8 mm	
Displacement	121 cu. in.	1984 ccm	
Compression ratio	10.3:1		
Fuel requirement	Unleaded Super, 95 RON (unleaded regular, 91 RON, as an alternative with slight reduction in performance)		
Horsepower (SAE)	200 hp @ 5100 - 6000 rpm		
Max. Torque	207 lb- ft. 280 Nm @ 1800 - 5000 rpm		
Max. Turbo boost (abs.)	1.8 bar		
ENGINE DESIGN:			
Cylinder block	Cast iron		
Crankshaft	Forged steel, 5 main bearings		
Cylinder head	Aluminum alloy		
Valve train / intake	DOHC, belt driven, hydraulic lifters		
Firing order	1-3-4-2		
Cooling system	Water-cooled, thermostatically controlled radiator fan		
Lubrication system	Gear pump, pressurized, full flow with oil cooler		
Fuel injection / Ignition system	Fully electronic engine management with drive-by-wire throttle control, direct injection, adaptive lambda control; mapped ignition with cylinder selective ignition coil, cylinder-selective adaptive knock control		
Emission system	Underbonnet ceramic precatalyst with catalyst heating function via homogenous split dual injection		
ELECTRICAL SYSTEM:			
Battery	12 volts	60 amp x h	
Alternator	14 volts	140 amp	
DRIVETRAIN:			
Transmission	Automatic: 6-speed Direct Shift Gearbox (DSG) with electro-hydraulic control		
	Manual:		
Type	200 hp FWD		200 hp FWD
	Automatic		Manual
Gear ratios:	1st	3.462	3.357
	2nd	2.150	2.087
	3rd	1.464	1.469
	4th	1.079	1.098
	5th	1.094	1.108
	6th	0.921	0.927
	Reverse	3.989	3.990
Final Drive front / rear	4.059 1st - 4th / 3.136 5th, 6th and reverse		3.944 1st - 4th / 3.087 5th, 6th and reverse
Front Differential	Hypoid gear, electronically locking (EDL)		
Center Differential	Haldex electronically controlled multi-plate coupling automatic and variable front to rear power proportioning		
Rear Differential	Hypoid gear		
STEERING:			
Type	Electromechanical steering with speed-dependent power assistance / 16.2/ approx. 10.7		
Ratio	16.2:1		
Turns (lock-to-lock)	3		
Turning circle (curb-to-curb)	35.11 ft.	10.7 m	
SUSPENSION:			
Front	Mc Pherson strut with lower wishbones, aluminium subframe, tubular anti-roll bar, track-stabilising steering roll radius		
Rear (fwd)	Four-link rear suspension with separate spring/shock absorber arrangement, subframe, tubular anti-roll bar		
Rear (quattro)	Four-link rear suspension with separate spring/shock absorber arrangement, subframe, tubular anti-roll bar		



2006 Audi A3 - Version 2
 Technical Specifications

Technical Specifications (continued)		Version 2	2005 A3 2.0T
BRAKES:			
Service brake	Dual-circuit brake system with diagonal split, ESP with electronic brake force distribution EBD, ABS; hydraulic brake assistent; brake servo with dual-rate function, electronic differential lock EDL, front: ventilates discs, rear: discs		
	2.0T 200hp FWD		
Front, size and type	12.3 in.	312 mm	- Vent. disc
Rear, size and type	11 in.	280 mm	disc
Parking brake	Mechanically actuated at the rear wheels		
WHEELS (standard only):			
Size	7.5J x 17 cast aluminum, 5 dome star spoke design		
TIRES (standard only):			
Size	225 / 45 R 17 Y all season		
BODY:			
Material			
Corrosion protection	Multi-step anti-corrosion protection	Cw = 0.33	
CAPACITIES:			
	Front wheel drive (200hp)		
Engine oil	4.8 qt.	4.6 liter	
Fuel tank	14.5 gal.	55 liter	
Cooling system	8.4 qt.	8 liter	(incl. heating)
EXTERIOR DIMENSIONS:			
	Front wheel drive (200 hp)		
Wheelbase	101.5 in.	2578 mm	
Track: front/rear	59.9/58.8 in.	1523 /1495 mm	
Overall length	168.7 in	4286 mm	
Overall width	77.1 in	1959 mm	(includes mirrors)
Height	56 in.	1423 mm	
Ground clearance	4.4 in.	113 mm	
Curb weight	3329 lbs.	1510 kg (automatic)	3263 1480 kg (manual)
Distribution % front / rear	61/39		60/40
INTERIOR DIMENSIONS:			
Seating Capacity	5		
EPA class	Five seater		
Head room	38.1 in.	970 mm	
Shoulder room	54.3 in.	1381 mm	
Leg room	41.2 in.	1047 mm	
Int. vol. (EPA)	N/A		
Luggage capacity (EPA)	13.06 cu. ft.	370 Liter	
PERFORMANCE:			
	200 hp FWD		200 hp FWD
	automatic		manual
0-60 mph	6.7 sec.		6.9 sec.
1/4 mile	15.5 sec.		15.6 sec.
Top speed	Electronically limited to 130 mph (209 km/h) for North America		
FUEL ECONOMY: EPA estimate			
	200 hp FWD		200 hp FWD
	automatic		manual
City	24 * mpg		23 * mpg
Highway	30 * mpg		30 * mpg *preliminary
Combined	27 * mpg		26 * mpg
FUEL ECONOMY: Canadian estimate			
	200 hp FWD (automatic)		200 hp FWD (manual)
City	9.7 liters/100km*		10.2 liters/100km* *preliminary
Highway	7.2 liters/100km*		7.1 liters/100km*